

***Living our Core Values
To create Value for you***



***Medic 142
Type III Ambulance***

..... Type III Medic 142SSB - Standard Features

CHASSIS FEATURES

- Ford E-350 DRW Cutaway, 6.0L diesel, 11,500# GVWR, 138" W.B.
- XL Trim with rubber floor mat
- MIRRORS: Ford OEM
- WHEELS: Stainless inserts w/braided fill tubes

BODY FEATURES

- MODULAR BODY: 142" x 90" body; fully welded tubular structure on 16" centers for strength and durability
- CROWN ROLLED ROOF: 3/4" to aid water disbursement
- REAR BUMPER: Aluminum w/flio-up center section to facilitate loading
- .125 BODY SIDESKIN: For added strength and a smooth unbroken finish
- FRONT WALL: 9" Recess for full driver seat travel
- O2 STORAGE: Streetside front wall for weight distribution



ENVIRONMENTAL FEATURES

- A/C - HEATER SYSTEM: 650 CFM blower unit, 32,000 BTU heat, 23,000 BTU cooling
- INSULATION: Fiberglass bats, spray foam optional
- VENT. POWER: Marine style with 3 speed fan

INTERIOR FEATURES

- INTERIOR HEIGHT: Minimum 66" of headroom
- DOME LIGHTS: (6) Dual element, halogen, two rows of three each, switched separately
- SPOTLIGHT: (1) 400,000CP hand-held light w/momentary switch, hard wired to OEM dash
- COT MOUNT: Ferno-Washington 175-3
- FLOORING: Loncin II Fleckstone with 4" rolled up sidewalls and recessed
- ALS CABINET: Storage for (2) 747 kits, Mon./Defib., medical cabinet, located at front bulk head
- HAZARDOUS WASTE/SHARPS DISPOSAL: Stainless steel A Bar at the head of the squadbench
- ASPIRATOR: Rico RS-4X disposable
- IV HOLDERS: (2) Dual, swing down rubber holders w/velcro retaining straps

POWER DISTRIBUTION / ELECTRICAL FEATURES

- ETCHED-TRACE POWER CIRCUITS: HD-3 oz. for increased service life
- ETCHED-TRACE CONTROL CIRCUITS: HD-3 oz. for dependable service
- MARINE GRADE HIGH CURRENT SWITCHES: Replaceable, for milliamp circuit, to improve switching dependability
- LED DIAGNOSTIC CONTROL AND DOOR OPEN CIRCUITS: To facilitate troubleshooting
- DOOR OPEN CIRCUITS: Magnetic/LED diagnostic circuit to reduce current drain
- HD MACHINE CRIMPED HARNESS: Pull and load tested, prewired for halogen, LED, or strobe lighting systems provides a rugged dependable network
- INVERTER: Prewired for 1000W inverter
- CLOCK: LED in rear control panel

WARNING LIGHTS & SIREN FEATURES

- FLASHER: Vanner 3860 GCPE
- INTERSECTION LIGHTS: (2) Whelen 700 Series Super LED
- GRILLE LIGHTS: (2) Whelen 500 Series LED
- WARNING LIGHTS: (10) Whelen 900 Series Halogens
- LOAD LIGHTS: (2) Whelen 900 Series
- SCENE LIGHTS: (4) Whelen 900 Series
- SIREN: Whelen WS-295HFS A7 Dual tone
- SPEAKERS: (2) CPI with 100w drivers
- BACK-UP ALARM: 97 Db with momentary cutoff

DOOR FEATURES

- LATCHES: TriMark automotive style for improved fit and finish
- HD - EXTRUDED DOOR JAMS: Kev locked and welded for improved fit
- HD - EXTRUDED DOOR FRAMES: .125 Pan formed skin for enhanced strength and improved finish
- INTEGRATED DOOR SEAL: Reduces wear on seal and eliminates outer contamination of doors, compartments and modules
- DOOR LINERS: .125 aluminum with Durable Multispec finish, attached with 10-24 stainless steel screws into aluminum rivnuts for service accessibility



WARRANTY

- 4 YEAR/48,000 MILE CONVERSION WARRANTY
- 15 YEAR STRUCTURAL WARRANTY
- 6 YEAR 72,000 MILE ELECTRICAL WARRANTY
- 7 YEAR PAINT WARRANTY - PPG DELFLEET PAINT PRODUCT SYSTEM



(shown w/additional options)



Standard Exterior



Std. Curb Side Option

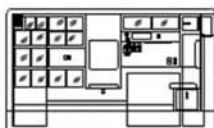

Standard Street Side

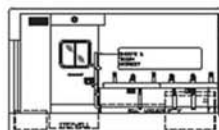

McCoy Miller

EXPORT SALES CONTACT :
METRONIX, INC.

12421 North Florida Ave., Suite D-201

Tampa, Florida 33612 – U.S.A.

PHONE: (813) 972-1212

FAX: (813) 932-4200

EMAIL: sales@metronixinc.com

WEBSITE: www.metronixinc.com

Due to constant product improvements: specifications, component parts and optional equipment are subject to change without notice or obligation. See your dealer for details.